

1. LAND EXCLUDES MINERALS AND IS SUBJECT TO RESERVATIONS
AND CONDITIONS IN FAVOUR OF THE CROWN - (SEE CROWN GRANTS)
2. OF 15.24 METRES BY THE CROWN GRANT
3. LAND EXCLUDES THE ROAD(S) BEING LOT 44 IN DP225906

- THE TITLE FOR LOT D IN DP374032 NOTES:
1. LAND EXCLUDES MINERALS AND IS SUBJECT TO RESERVATIONS
AND CONDITIONS IN FAVOUR OF THE CROWN - (SEE CROWN GRANTS)
2. LAND EXCLUDES THE ROAD(S) BEING LOT 43 IN DP225906

- THE TITLE FOR LOT A IN DP374032 NOTES:
1. LAND EXCLUDES MINERALS AND IS SUBJECT TO RESERVATIONS
AND CONDITIONS IN FAVOUR OF THE CROWN - (SEE CROWN GRANTS)

- THE TITLE FOR LOT B IN DP374032 NOTES:
1. LAND EXCLUDES MINERALS AND IS SUBJECT TO RESERVATIONS
AND CONDITIONS IN FAVOUR OF THE CROWN - (SEE CROWN GRANTS)

- THE TITLE FOR LOT C IN DP374032 NOTES:
1. LAND EXCLUDES MINERALS AND IS SUBJECT TO RESERVATIONS
AND CONDITIONS IN FAVOUR OF THE CROWN - (SEE CROWN GRANTS)

- THE TITLE FOR LOT C IN DP374032 NOTES:
1. LAND EXCLUDES MINERALS AND IS SUBJECT TO RESERVATIONS
AND CONDITIONS IN FAVOUR OF THE CROWN - (SEE CROWN GRANTS)

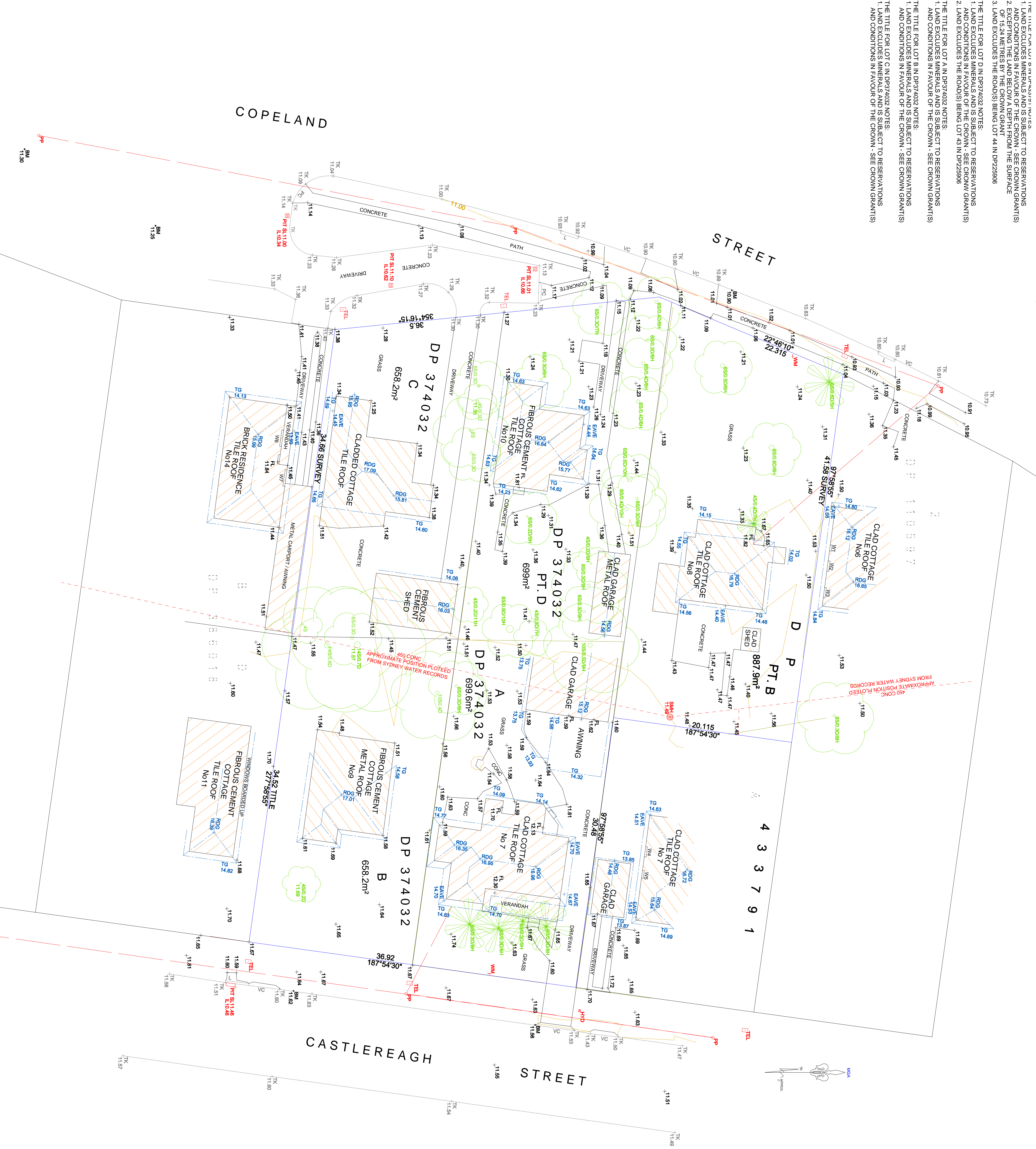

NOTES:

- * BOUNDARIES HAVE NOT BEEN DEFINED BY SURVEY AND ARE DIAGRAMMATIC ONLY.
- * LAND DIMENSIONS AND AREAS HAVE BEEN COMPILED FROM PLANS OBTAINED FROM LIMA.
- * BEARINGS RELATED TO MGA NORTH ORIGINATING FROM DP1653951
- * LEVEL DATUM IS AND ORIGINATING FROM SSM26174
- * VISUAL ACCESSIBLE SERVICES ONLY HAVE BEEN LOCATED
- * THE EXISTENCE OF UNDERGROUND SERVICES HAS NOT BEEN INVESTIGATED. IF THESE ARE CRITICAL IT IS ESSENTIAL THE APPROPRIATE AUTHORITIES BE NOTIFIED AND THE SERVICES BE LOCATED BY UNDERGROUND DETECTION METHODS OR POT-HOLES AND THEN SURVEY NEIGHBOURING HOUSES, WINDOWS AND ROOF POSITIONS ARE APPROXIMATE ONLY.
- * THESE LEVELS GENERAL ROOMS NOT SURVEYED
- * CONTROLS SHOWN ARE INDICATIVE OF LAND FORM.
- * SPOT LEVELS SHOULD TAKE PRECEDENCE.
- * REFER TO FACE OF PLAN FOR SUBJECT TITLE NOTATIONS.
- * THIS TITLEBLOCK IS AN INTEGRAL PART OF THIS DRAWING AND SHOULD NOT BE REMOVED.



LEGEND

- HYD - HYDRANT
- SL - SURFACE LEVEL
- L - DOWNWATER LINTEL
- FL - INVERT LEVEL
- PC - PAVEMENT CROSSING
- PP - POWER POLE
- SMH - SEWER MANHOLE
- TK - TOP KERB
- TG - TOP GUTTER
- TEL - TELSTRA PIT
- VC - RIDGE
- WM - WATER METER
- 450ZD/H - SPREAD, DIAMETER, HEIGHT

© PROJECT SURVEYORS - 2014
REPRODUCTION WITHOUT WRITTEN
APPROVAL IS STRICTLY PROHIBITED

REV	AMENDMENTS	DATE

SHEET 1 OF 1 - DETAIL SURVEY

CLIENT: CASTLEREAGH STREET
DEVELOPMENTS PTY LTD

SURVEYOR : KURT F.
DATA : AUSTRALIAN HEIGHT DATUM
ORIGIN : SSM 26174 RL10.628
JOB REF : B1674
COMPUTER REF : B1674-1
DRAWING NO : B1674-1
DATE OF SURVEY : 23 JULY 2014
CHECKED :
REDUCTION RATIO : 1:200

PLAN OF: NO7 & 9 CASTLEREAGH STREET AND
NO8, 10 & 12 IN COPELAND STREET,
LIVERPOOL.

BEING:
PT LOT B IN DP433791 AND
LOTS A-C AND PT D IN DP374032

SHOWING: GENERAL DETAIL AND
SITE LEVELS

PURPOSE: ARCHITECTURAL DESIGN
COUNCIL SUBMISSION

MACQUARIE PARK

PO Box 4004 MACQUARIE CENTRE NSW 2113
SUITE 404, LEVEL 4 NO13-15 LYON PARK ROAD,
MACQUARIE PARK NSW 2113
PHONE : 9888 3848 FAX : 9888 3875
email: office@projectsurveyors.com.au

www.projectsurveyors.com.au

SCHEDULE OF WINDOWS

No.	SILL	HEAD
W1	13.25	14.15
W2	13.05	14.15
W3	13.05	14.15
W4	13.05	14.15
W5	14.15	14.15
W6	13.95	14.15
W7	13.95	14.15